

ELECTRIC TOOL PARTS LIST

■ HAMMER DRILL
Model DH 50SA

1992 · 1 · 29
(E4)

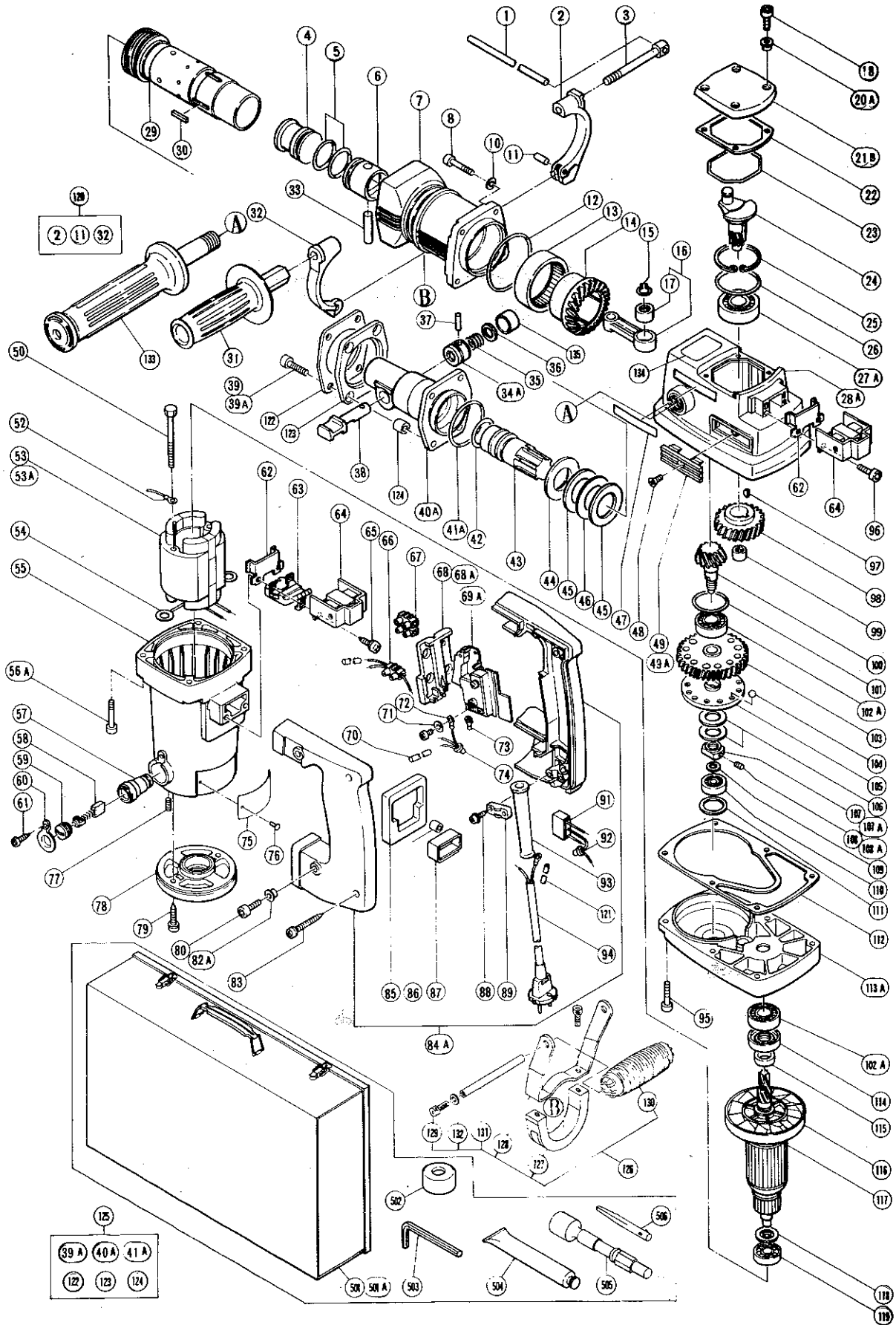

PARTS

DH 50SA

ITEM NO.	CODE NO.	DESCRIPTION	NO. USED	REMARKS
1	971-786	STOPPER ROD	1	
2	985-475	HANDLE HOLDER (A)	1	
3	985-465	HANDLE BOLT	1	
4	985-776	STRIKER	1	
5	985-773	O - RING (A)	2	
6	985-772	PISTON	1	
7	985-777	CYLINDER CASE	1	
8	949-692	HEX. SOCKET HD. BOLT M6X35 (10 PCS.)	4	
10	949-432	BOLT WASHER M6 (10 PCS.)	4	
11	949-747	ROLL PIN D6X25 (10 PCS.)	1	
12	985-779	O - RING (D)	1	
13	985-782	NEEDLE BEARING (M526320)	1	
14	985-775	THIRD GEAR	1	
15	939-542	RETAINING RING FOR D12 SHAFT (10 PCS.)	1	
16	985-771	CONNECTING ROD ASS'Y	1	INCLUD.17
17	980-756	NEEDLE BEARING (NSK AJ50 1203)	1	
18	983-162	SEAL LOCK HEX. SOCKET HD. BOLT M4X12	4	
20A	990-146	DISTANCE PIECE (A)	4	TILL 1.1988
21B	991-716	CRANK COVER	1	
22	980-749	SEAL PACKING	1	
23	980-744	O - RING (S - 55)	1	
24	985-763	CRANK SHAFT	1	
25	948-227	RETAINING RING FOR D47 HOLE	1	
26	985-765	O - RING (B)	1	
27A	620-4DD	BALL BEARING 6204DDUCMPS2S	1	
28A	987-020	CRANK CASE ASS'Y	1	INCLUD.49A
29	986-880	CYLINDER	1	
30	971-750	FEATHER KEY 3X3X20	4	
31	985-477	SIDE HANDLE	1	
32	985-476	HANDLE HOLDER (B)	1	
33	955-593	PISTON PIN	1	
34A	985-466	SPRING CASE	1	
35	981-937	STOPPER SPRING	1	
36	985-463	STOPPER WASHER	1	
37	943-364	NEEDLE ROLLER D4X20	1	
38	986-888	STOP LEVER	1	
39	985-479	SEAL LOCK HEX. SOCKET HD. BOLT M8X25	4	TILL 2.1984
39A	986-894	SEAL LOCK HEX. SOCKET HD. BOLT M8X30	4	SINCE 3.1984
40A	986-897	FRONT COVER	1	SINCE 3.1984
41A	986-896	O - RING (F)	1	SINCE 3.1984
42	986-882	O - RING	1	
43	986-881	SECOND HAMMER	1	
44	986-885	DAMPER WASHER	1	
45	986-883	DAMPER	2	
46	986-884	WASHER	1	
47	957-561	HITACHI LABEL	1	
48	949-323	FLAT HD. SCREW M4X12 (10 PCS.)	2	TILL 7.1987
49	980-735	WIND GUIDE	2	TILL 7.1987
49A	991-713	WIND GUIDE (B)	2	SINCE 8.1987
50	961-400	HEX. HD. TAPPING SCREW D5X70	2	
* 52	971-776	INTERNAL WIRE	1	FOR SUI

*: ALTERNATIVE PARTS

PARTS

DH 50SA

ITEM NO.	CODE NO.	DESCRIPTION	NO. USED	REMARKS
* 52	986-277	INTERNAL WIRE	1	
* 53	985-471C	STATOR ASS'Y 110V - 115V	1	INCLUD.54
* 53	985-471D	STATOR ASS'Y 120V - 127V	1	INCLUD.54
* 53	985-471E	STATOR ASS'Y 220V - 230V	1	INCLUD.54
* 53	985-471F	STATOR ASS'Y 240V	1	INCLUD.54
* 53	985-471J	STATOR ASS'Y 110V	1	INCLUD.54 FOR GBR
* 53A	985-471G	STATOR ASS'Y 220V - 230V	1	INCLUD.54 FOR NZL,SAF,ITA,FRG,FRA,HOL, DEN,FIN,SWE,AUT,SUI
* 53A	985-471H	STATOR ASS'Y 240V	1	INCLUD.54 FOR AUS <i>1,18-52</i>
54	937-623	BRUSH TERMINAL	2	
55	985-435	HOUSING ASS'Y	1	INCLUD.57,77
56A	994-085	HEX. SOCKET HD. BOLT (W/FLANGE) M6X60	4	
57	983-362	BRUSH HOLDER	2	
58	961-946Z	CARBON BRUSH (AUTO STOP TYPE) (1 PAIR)	2	
59	961-781	BRUSH CAP	2	
60	981-959	CAP COVER	2	
61	958-715	TAPPING SCREW D4X10	2	
62	980-750	GUIDE PLATE	2	
63	985-469	INTERNAL WIRE HOLDER	1	
64	980-727	HANDLE RUBBER	2	
65	985-605	TAPPING SCREW (W/WASHER) D5X25	2	
* 66	938-307Z	PILLAR TERMINAL	1	FOR GBR,ITA,FRG,FRA,HOL,DEN,FIN,SWE, AUT,SIN,USA,CAN
* 67	958-308Z	PILLAR TERMINAL (A)	1	FOR FIN
* 68	981-869	SUPPORT	1	TILL 3.1987
* 68	981-986Z	SUPPORT (A)	1	FOR AUS
* 68A	990-082	SUPPORT (E)	1	SINCE 4.1987
* 69A	992-891	SWITCH (A) (1P SCREW TYPE) W/O LOCK	1	
* 69A	981-533Z	SWITCH (2P PILLAR TYPE) W/O LOCK	1	FOR AUS
70		VINYL TUBE (A) (I.D.7XT0.5X50)	2	
* 71	949-423	WASHER M4 (10 PCS.)	1	FOR GBR,ITA,FRG,FRA,HOL,DEN,FIN,SWE, AUT,SUI
* 72	983-276Z	INTERNAL WIRE	1	FOR NZL,GBR,SAF,ITA,FRG,FRA,HOL,DEN, FIN,SWE,AUT,SUI
* 73	959-144	TERMINAL 50051 (10 PCS.)	1	FOR KUW,NGU
* 74	959-141	CONNECTOR 50092 (10 PCS.)	2	FOR NZL,GBR,SAF,ITA,FRG,FRA,HOL,DEN, SWE,AUT,SUI
75		NAME PLATE	1	
76	949-510	RIVET D2.5X4.8 (10 PCS.)	2	
77	982-169	HEX. SOCKET SET SCREW M5X12	2	
78	985-437	TAIL COVER	1	
79	985-480	TAPPING SCREW (W/WASHER) D5X20	2	
80	949-765	HEX. SOCKET HD. BOLT M5X12 (10 PCS.)	4	
82A	991-711	DISTANCE PIECE (B)	4	
83	956-636	TAPPING SCREW (W/WASHER) D4X25	2	
84A	993-254	HANDLE (A),(B) SET	1	POLYAMIDE RESIN
85	980-751	HANDLE PACKING	1	
86		VINYL TUBE (I.D.9XT0.5X25)	1	TILL 4.1987
* 87	985-474	WIRE SUPPORT	1	FOR USA
88	984-750	TAPPING SCREW (W/FLANGE) D4X16	2	
* 89	980-266	CORD CLIP	1	

*: ALTERNATIVE PARTS

PARTS

DH 50SA

ITEM NO.	CODE NO.	DESCRIPTION	NO. USED	REMARKS
* 89	981-987Z	CORD CLIP	1	FOR SUI
* 91	994-273	NOISE SUPPRESSOR	1	
* 92	959-140	CONNECTOR 50091 (10 PCS.)	1	
* 93	958-049Z	CORD ARMOR D8.2	1	
* 93	940-778	CORD ARMOR D10.7	1	
* 94	500-224Z	CORD	1	(CORD ARMOR D10.7) FOR SIN,KUW
* 94	500-227Z	CORD	1	(CORD ARMOR D8.2) FOR NGU,NZL
* 94	500-232Z	CORD	1	(CORD ARMOR D8.2) FOR SAF
* 94	500-235Z	CORD	1	(CORD ARMOR D8.2) FOR INA,SUR,MLT
* 94	500-239Z	CORD	1	(CORD ARMOR D10.7)
* 94	500-390Z	CORD	1	(CORD ARMOR D10.7) FOR ITA,FRG,FRA, HOL,DEN,SWE,AUT
* 94	500-391Z	CORD	1	(CORD ARMOR D10.7) FOR SUI
* 94	500-394Z	CORD	1	(CORD ARMOR D10.7) FOR SYR
* 94	500-406Z	CORD	1	(CORD ARMOR D8.2) FOR GBR
* 94	500-407Z	CORD	1	(CORD ARMOR D10.7) FOR USA,CAN
* 94	500-408Z	CORD	1	(CORD ARMOR D10.7) FOR AUS
95	949-660	HEX. SOCKET HD. BOLT M6X20 (10 PCS.)	2	
96	949-665	HEX. SOCKET HD. BOLT M5X14 (10 PCS.)	2	
97	932-815	WOODRUFF KEY 3X13	1	
98	985-764	FIRST GEAR	1	
99	939-299	NEEDLE BEARING (M661)	1	
100	985-770	THIRD PINION	1	
101	984-483	O - RING (S - 36)	1	
102A	620-2DD	BALL BEARING 620DDUCMPS2S	1	
103	985-766	SECOND GEAR	1	
104	959-150	STEEL BALL D6.35 (10 PCS.)	17	
105	985-767	CLUTCH PLATE	1	
106	985-768	BELLEVILLE SPRING	2	
107	985-783	SPECIAL NUT	1	TILL 2.1988
107A	300-042	SPECIAL NUT	1	SINCE 3.1988
108	962-782	HEX. SOCKET SET SCREW M5X6	1	TILL 2.1988
108A	985-033	HEX. SOCKET SET SCREW M6X6	1	SINCE 3.1988
109	944-516	BEARING WASHER (B)	1	
110	629-MC2	BALL BEARING 629MC2E	1	
111	944-525	BEARING WASHER (C)	1	
112	985-769	SEAL PACKING	1	
113A	993-248	GEAR COVER	1	
114	985-439	OIL SEAL (FPM 807)	1	
115	985-438	SLEEVE	1	
116	985-482	FAN	1	
* 117	985-784C	ARMATURE ASS'Y 110V - 115V	1	INCLUD.116
* 117	985-784D	ARMATURE ASS'Y 120V - 127V	1	INCLUD.116
* 117	985-784E	ARMATURE ASS'Y 220V - 230V	1	INCLUD.116
* 117	985-784F	ARMATURE ASS'Y 240V	1	INCLUD.116
* 117	985-784G	ARMATURE ASS'Y 220V	1	INCLUD.116 FOR ITA,FRG,FRA,HOL,DEN, FIN,SWE,AUT,SUI
* 117	985-784H	ARMATURE ASS'Y 240V	1	INCLUD.116 FOR GBR
* 117	985-784J	ARMATURE ASS'Y 110V	1	INCLUD.116 FOR GBR
118	985-436	DUST WASHER	1	
119	620-0VV	BALL BEARING 6200VVCMP2S	1	

*: ALTERNATIVE PARTS

OPTIONAL ACCESSORIES

DH 50SA

ITEM NO.	CODE NO.	DESCRIPTION	NO. USED	REMARKS
601	986-980	DRILL BIT D16.0X420 (HEX. SHANK TYPE)	1	
602	986-981	DRILL BIT D16.0X570 (HEX. SHANK TYPE)	1	
603	986-982	DRILL BIT D18.0X420 (HEX. SHANK TYPE)	1	
604	986-983	DRILL BIT D18.0X570 (HEX. SHANK TYPE)	1	
605	986-984	DRILL BIT D20.0X420 (HEX. SHANK TYPE)	1	
606	986-985	DRILL BIT D20.0X570 (HEX. SHANK TYPE)	1	
607	986-986	DRILL BIT D22.0X420 (HEX. SHANK TYPE)	1	
608	986-987	DRILL BIT D22.0X570 (HEX. SHANK TYPE)	1	
609	986-988	DRILL BIT D25.0X420 (HEX. SHANK TYPE)	1	
610	986-989	DRILL BIT D25.0X570 (HEX. SHANK TYPE)	1	
611	986-990	DRILL BIT D28.0X420 (HEX. SHANK TYPE)	1	
612	986-991	DRILL BIT D28.0X570 (HEX. SHANK TYPE)	1	
613	986-992	DRILL BIT D30.0X420 (HEX. SHANK TYPE)	1	
614	986-993	DRILL BIT D30.0X570 (HEX. SHANK TYPE)	1	
615	986-994	DRILL BIT D32.0X420 (HEX. SHANK TYPE)	1	
616	986-995	DRILL BIT D32.0X570 (HEX. SHANK TYPE)	1	
617	986-996	DRILL BIT D35.0X420 (HEX. SHANK TYPE)	1	
618	986-997	DRILL BIT D35.0X570 (HEX. SHANK TYPE)	1	
619	986-998	DRILL BIT D38.0X420 (HEX. SHANK TYPE)	1	
620	986-999	DRILL BIT D38.0X570 (HEX. SHANK TYPE)	1	
621	987-000	DRILL BIT D40.0X420 (HEX. SHANK TYPE)	1	
622	987-001	DRILL BIT D40.0X570 (HEX. SHANK TYPE)	1	
623	987-002	DRILL BIT D44.0X570 (HEX. SHANK TYPE)	1	
624	987-003	DRILL BIT D50.0X420 (HEX. SHANK TYPE)	1	
625	987-004	DRILL BIT D50.0X570 (HEX. SHANK TYPE)	1	
626	987-018	K - TAPER SHANK ADAPTER	1	SINCE 12.1984
627	987-006	A - TAPER SLEEVE	1	
628	987-007	COTTER	1	
629	987-009	CORE BIT 65MM	1	
630	987-010	CORE BIT 80MM	1	
631	987-011	CORE BIT 90MM	1	
632	987-012	CORE BIT 100MM	1	
633	987-013	CORE BIT 125MM	1	
634	987-014	CORE BIT SHANK	1	
635	955-165	CENTER PIN (A) 133L FOR CORE BIT D38 - 120	1	
636	985-380	CORE BIT 50MM	1	
637	984-028	RATIO SHANK ADAPTER	1	
638	980-927	GREASE FOR IMPACT DRILL (500G)	1	
639	944-575	SYRINGE	1	
640	986-947	BULL POINT 300MM	1	
641	986-948	BULL POINT 380MM	1	
642	986-949	BULL POINT 450MM	1	
643	986-952	COLD CHISEL 300MM	1	
644	986-953	COLD CHISEL 380MM	1	
645	986-954	COLD CHISEL 450MM	1	
646	986-950	CUTTER W50X400L	1	
647	986-951	CUTTER W75X400L	1	
648	987-021	SERVICE KIT (DH 50SA)	1	INCLUD 5,12,15,22,23,39A,41A,42,45,58,112, 123,504

*: ALTERNATIVE PARTS