

# ELECTRIC TOOL PARTS LIST

**HAMMER DRILL**  
**Model DH 38YB**

**1992 · 1 · 29**  
**(E4)**

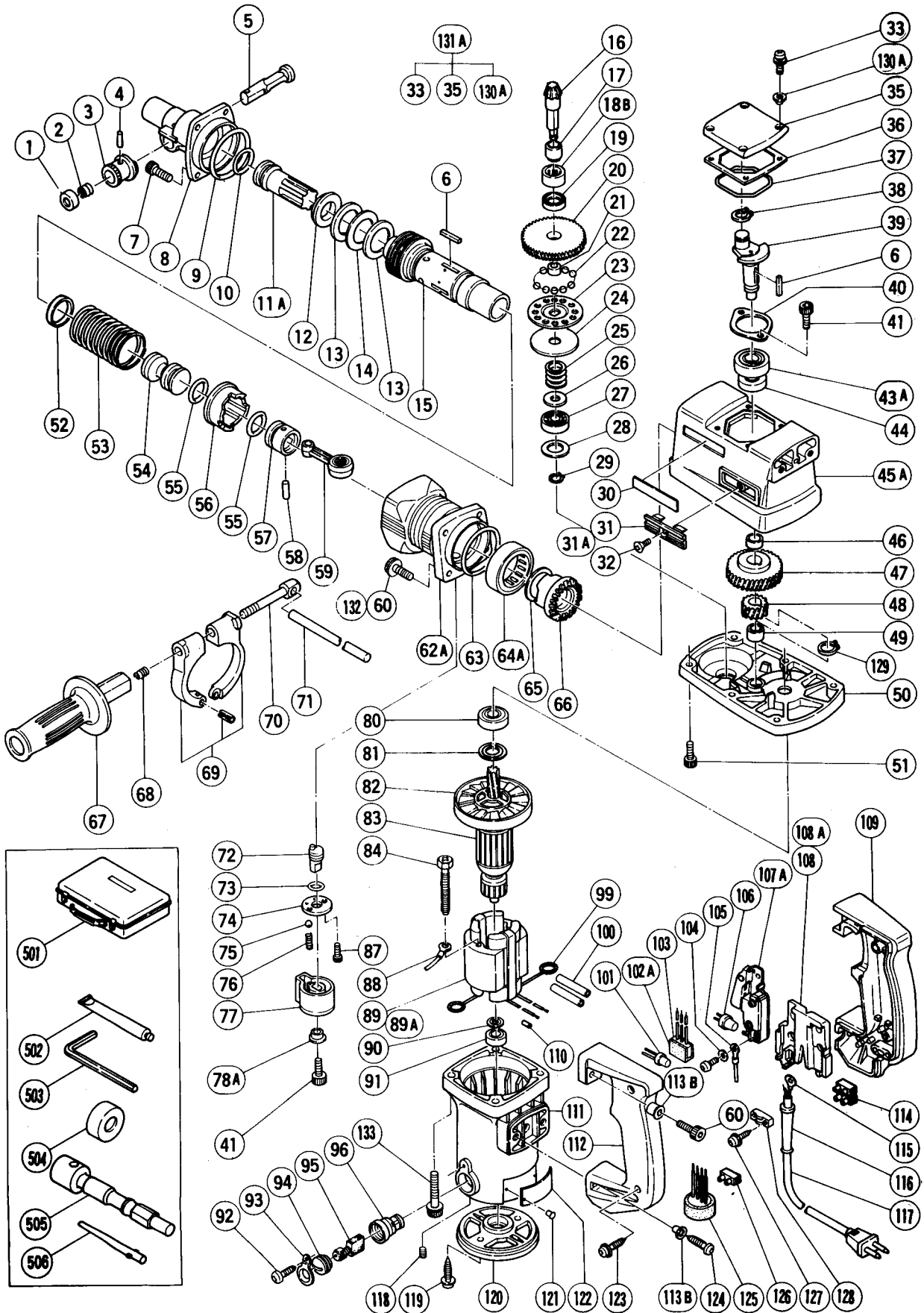

## PARTS

DH 38YB

| ITEM NO. | CODE NO. | DESCRIPTION                            | NO. USED | REMARKS           |
|----------|----------|--|----------|-------------------|
| 1        | 986-824  | STOP WASHER                            | 1        |                   |
| 2        | 981-937  | STOPPER SPRING                         | 1        |                   |
| 3        | 983-241  | KNOB (A)                               | 1        |                   |
| 4        | 943-364  | NEEDLE ROLLER D4X20                    | 1        |                   |
| 5        | 983-240  | STOP LEVER                             | 1        |                   |
| 6        | 971-750  | FEATHER KEY 3X3X20                     | 5        |                   |
| 7        | 991-696  | SEAL LOCK BOLT M7X25                   | 4        |                   |
| 8        | 992-801  | FRONT COVER                            | 1        |                   |
| 9        | 985-780  | O - RING (E)                           | 1        |                   |
| 10       | 981-857  | O - RING (C)                           | 1        |                   |
| 11A      | 990-144  | SECOND HAMMER                          | 1        |                   |
| 12       | 981-862  | DAMPER WASHER                          | 1        |                   |
| 13       | 992-799  | DAMPER                                 | 2        |                   |
| 14       | 992-798  | WASHER                                 | 1        |                   |
| 15       | 992-797  | CYLINDER                               | 1        |                   |
| 16       | 992-796  | THIRD PINION                           | 1        |                   |
| 17       | 981-850  | SLEEVE                                 | 1        |                   |
| 18B      | 981-852  | NEEDLE BEARING (A) HK2012              | 1        |                   |
| 19       | 981-851  | OIL SEAL (B)                           | 1        |                   |
| 20       | 992-795  | SECOND GEAR                            | 1        |                   |
| 21       | 992-806  | METAL                                  | 1        |                   |
| 22       | 959-150  | STEEL BALL D6.35 (10 PCS.)             | 12       |                   |
| 23       | 992-792  | HOLDER                                 | 1        |                   |
| 24       | 992-793  | PLATE                                  | 1        |                   |
| 25       | 992-794  | SPRING                                 | 1        |                   |
| 26       | 992-791  | WASHER                                 | 1        |                   |
| 27       | 629-VVM  | BALL BEARING 629VVMC2EPS2L             | 1        |                   |
| 28       | 944-525  | BEARING WASHER (C)                     | 1        |                   |
| 29       | 992-805  | RETAINING RING FOR D8 SHAFT            | 1        |                   |
| 30       | 957-561  | HITACHI LABEL                          | 1        |                   |
| 31       | 980-735  | WIND GUIDE                             | 2        | TILL 5.1987       |
| 31A      | 991-713  | WIND GUIDE (B)                         | 2        | SINCE 6.1987      |
| 32       | 990-430  | SEAL LOCK FLAT HD. SCREW M4X10         | 2        | TILL 5.1987       |
| 33       | 987-203  | SEAL LOCK SCREW (W/SP. WASHER) M4X12   | 4        |                   |
| 35       | 993-903  | CRANK COVER ASS'Y                      | 1        |                   |
| 36       | 980-749  | SEAL PACKING                           | 1        |                   |
| 37       | 980-744  | O - RING (S - 55)                      | 1        |                   |
| 38       | 939-542  | RETAINING RING FOR D12 SHAFT (10 PCS.) | 1        |                   |
| 39       | 991-954  | CRANK SHAFT                            | 1        |                   |
| 40       | 981-847  | BEARING COVER                          | 1        |                   |
| 41       | 984-509  | SEAL LOCK HEX. SOCKET HD. BOLT M5X14   | 3        |                   |
| 43A      | 620-3DD  | BALL BEARING 6203DDUCMAV2S             | 1        |                   |
| 44       | 971-745  | OIL SEAL (A)                           | 1        |                   |
| 45A      | 991-768  | CRANK CASE                             | 1        | INCLUD.18B,19,31A |
| 46       | 980-706  | COLLAR                                 | 1        |                   |
| 47       | 981-845  | FIRST GEAR                             | 1        |                   |
| 48       | 981-846  | SECOND PINION                          | 1        |                   |
| 49       | 939-299  | NEEDLE BEARING (M661)                  | 1        |                   |
| 50       | 991-953  | GEAR COVER                             | 1        |                   |
| 51       | 992-803  | SEAL LOCK HEX. SOCKET HD. BOLT M6X20   | 2        |                   |
| 52       | 981-858  | VALVE BAND                             | 1        |                   |

\*: ALTERNATIVE PARTS

**PARTS**

**DH 38YB**

| ITEM NO. | CODE NO. | DESCRIPTION                          | NO. USED                   | REMARKS   |
|----------|----------|--------------------------------------|----------------------------|---|
| 53       | 981-957  | SPRING (A)                           | 1                          |   |
| 54       | 981-855  | STRIKER                              | 1                          |   |
| 55       | 986-104  | O - RING                             | 2                          |   |
| 56       | 981-956  | CLUTCH                               | 1                          |   |
| 57       | 981-885  | PISTON                               | 1                          |   |
| 58       | 980-708  | PISTON PIN                           | 1                          |   |
| 59       | 980-707  | CONNECTING ROD ASS'Y                 | 1                          |   |
| 60       | 987-707  | SEAL LOCK HEX. SOCKET HD. BOLT M6X25 | 6                          | TILL 11.1984  |
| 60       | 987-707  | SEAL LOCK HEX. SOCKET HD. BOLT M6X25 | 2                          | SINCE 12.1984 FOR HANDLE (A)  |
| 62A      | 993-902  | CYLINDER CASE                        | 1                          |   |
| 63       | 956-996  | O - RING (1AS - 60)                  | 1                          |   |
| 64A      | 993-069  | NEEDLE BEARING (M455520)             | 1                          |   |
| 65       | 981-955  | THRUST WASHER                        | 1                          |   |
| 66       | 981-954  | THIRD GEAR                           | 1                          |   |
| 67       | 981-870  | SIDE HANDLE                          | 1                          |   |
| 68       | 672-612  | SPRING                               | 1                          |   |
| 69       | 981-960  | HANDLE HOLDER                        | 1                          |   |
| 70       | 971-785  | HANDLE BOLT                          | 1                          |   |
| 71       | 971-786  | STOPPER ROD                          | 1                          |   |
| 72       | 981-964  | LEVER SHAFT                          | 1                          |   |
| 73       | 981-967  | O - RING (A)                         | 1                          |   |
| 74       | 981-965  | SHAFT COVER                          | 1                          |   |
| 75       | 959-155  | STEEL BALL D3.97 (10 PCS.)           | 1                          |   |
| 76       | 981-966  | SPRING (B)                           | 1                          |   |
| 77       | 981-963  | LEVER                                | 1                          |   |
| 78A      | 991-711  | DISTANCE PIECE (B)                   | 1                          |   |
| 80       | 620-2VV  | BALL BEARING 6202VVCMP2S             | 1                          |   |
| 81       | 980-700  | DUST WASHER (B)                      | 1                          |   |
| 82       | 980-740  | FAN                                  | 1                          |   |
| *        | 83       | 981-971U                             | ARMATURE ASS'Y 110V - 115V | 1 INCLUD.80,81,82,90,91   |
| *        | 83       | 981-971D                             | ARMATURE ASS'Y 120V - 127V | 1 INCLUD.82   |
| *        | 83       | 981-971L                             | ARMATURE ASS'Y 220V - 230V | 1 INCLUD.82   |
| *        | 83       | 981-971H                             | ARMATURE ASS'Y 240V        | 1 INCLUD.82   |
| *        | 83       | 981-971J                             | ARMATURE ASS'Y 110V        | 1 INCLUD.82 FOR GBR   |
| 84       | 960-251  | HEX. HD. TAPPING SCREW D5X65         | 2                          |   |
| 87       | 983-162  | SEAL LOCK HEX. SOCKET HD. BOLT M4X12 | 2                          |   |
| *        | 88       | 986-277                              | INTERNAL WIRE              | 1 FOR NZL,GBR,SAF,ITA,FRG,FRA,ESP,HOL,<br>DEN,FIN,SWE,AUT                   |
| *        | 89       | 981-970C                             | STATOR ASS'Y 110V - 115V   | 1 INCLUD.99   |
| *        | 89       | 981-970D                             | STATOR ASS'Y 120V - 127V   | 1 INCLUD.99   |
| *        | 89       | 981-970E                             | STATOR ASS'Y 220V - 230V   | 1 INCLUD.99   |
| *        | 89       | 981-970F                             | STATOR ASS'Y 240V          | 1 INCLUD.99   |
| *        | 89       | 981-970H                             | STATOR ASS'Y 240V          | 1 INCLUD.99,110 FOR AUS   |
| *        | 89       | 981-970J                             | STATOR ASS'Y 110V          | 1 INCLUD.99 FOR GBR   |
| *        | 89A      | 981-970K                             | STATOR ASS'Y 220V - 230V   | 1 INCLUD.99 FOR NZL,SAF,ITA,FRG,FRA,DEN,<br>FIN,SWE,NOR,ESP,POR,SUI,HOL,AUT |
| 90       | 980-698  | DUST WASHER (A)                      | 1                          |   |
| 91       | 608-VVM  | BALL BEARING 608VVMC2EPS2L           | 1                          |   |
| 92       | 958-715  | TAPPING SCREW D4X10                  | 2                          |   |
| 93       | 981-959  | CAP COVER                            | 2                          |   |
| 94       | 961-781  | BRUSH CAP                            | 2                          |   |

\*: ALTERNATIVE PARTS

## PARTS

DH 38YB

| ITEM NO. | CODE NO. | DESCRIPTION                            | NO. USED | REMARKS  |
|----------|----------|--|----------|--|
| 95       | 981-612Z | CARBON BRUSH (AUTO STOP TYPE) (1 PAIR) | 2        |  |
| 96       | 981-586  | BRUSH HOLDER                           | 2        |  |
| 99       | 930-703  | BRUSH TERMINAL                         | 2        |  |
| 100      |          | VINYL TUBE (I.D.7XTO.5X120)            | 1        |  |
| * 101    | 959-140  | CONNECTOR 50091 (10 PCS.)              | 2        |  |
| * 102A   | 963-243  | SUPPORT                                | 1        | FOR NOISE SUPPRESSOR                                       |
| * 103    | 994-273  | NOISE SUPPRESSOR                       | 1        |  |
| * 104    | 949-423  | WASHER M4 (10 PCS.)                    | 1        | FOR GBR,ITA,FRG,FRA,ESP,HOL,DEN,FIN,<br>SWE,AUT,SUI        |
| * 105    | 981-974Z | INTERNAL WIRE                          | 1        | FOR GBR,SAF,ITA,FRG,FRA,ESP,HOL,DEN,<br>FIN,SWE,AUT,SUI    |
| * 106    | 959-141  | CONNECTOR 50092 (10 PCS.)              | 2        |  |
| * 107A   | 990-941  | SWITCH (B) (1P SCREW TYPE) W/O LOCK    | 1        |  |
| * 107A   | 981-533Z | SWITCH (2P PILLAR TYPE) W/O LOCK       | 1        | FOR AUS  |
| * 108    | 981-869  | SUPPORT                                | 1        | TILL 10.1987   |
| * 108    | 981-986Z | SUPPORT (A)                            | 1        | FOR AUS  |
| * 108A   | 990-082  | SUPPORT (E)                            | 1        | SINCE 11.1987  |
| * 109    | 992-808  | HANDLE (A)                             | 1        |  |
| * 109    | 981-866  | HANDLE (A)                             | 1        | FOR AUS  |
| * 110    | 981-373  | TUBE (D)                               | 2        |  |
| 111      | 992-790  | HOUSING ASS'Y                          | 1        | INCLUD.96,118  |
| * 112    | 992-809  | HANDLE (B)                             | 1        |  |
| * 112    | 981-867  | HANDLE (B)                             | 1        | FOR AUS  |
| 113B     | 990-940  | DISTANCE PIECE (C)                     | 4        |  |
| * 114    | 958-308Z | PILLAR TERMINAL (A)                    | 1        | FOR FIN  |
| * 115    | 992-810  | TERMINAL                               | 1        | FOR ITA,FRG,FRA,HOL,DEN,FIN,SWE,AUT                        |
| * 116    | 958-049Z | CORD ARMOR D8.2                        | 1        |  |
| * 116    | 940-778  | CORD ARMOR D10.7                       | 1        |  |
| * 117    | 500-239Z | CORD                                   | 1        | (CORD ARMOR D10.7)   |
| * 117    | 500-224Z | CORD                                   | 1        | (CORD ARMOR D10.7) FOR SIN,KUW                             |
| * 117    | 500-227Z | CORD                                   | 1        | (CORD ARMOR D8.2) FOR NGU,NZL                              |
| * 117    | 500-232Z | CORD                                   | 1        | (CORD ARMOR D8.2) FOR SAF                                  |
| * 117    | 500-235Z | CORD                                   | 1        | (CORD ARMOR D8.2)FOR INA,SUR,DEN,<br>SWE,NO                |
| * 117    | 500-249Z | CORD                                   | 1        | (CORD ARMOR D8.2) FOR CAN                                  |
| * 117    | 500-390Z | CORD                                   | 1        | (CORD ARMOR D10.7) FOR ITA,FRG,FRA,<br>HOL,DEN,FIN,SWE,AUT |
| * 117    | 500-391Z | CORD                                   | 1        | (CORD ARMOR D10.7) FOR SUI                                 |
| * 117    | 500-394Z | CORD                                   | 1        | (CORD ARMOR D10.7) FOR SYR,ESP                             |
| * 117    | 500-406Z | CORD                                   | 1        | (CORD ARMOR D8.2) FOR GBR                                  |
| * 117    | 500-410Z | CORD                                   | 1        | (CORD ARMOR D10.7) FOR AUS                                 |
| 118      | 938-477  | HEX. SOCKET SET SCREW M5X8             | 2        |  |
| 119      | 985-480  | TAPPING SCREW (W/WASHER) D5X20         | 2        |  |
| 120      | 302-323  | TAIL COVER (B)                         | 1        |  |
| 121      | 949-510  | RIVET D2.5X4.8 (10 PCS.)               | 2        |  |
| 122      |          | NAME PLATE                             | 1        |  |
| 123      | 956-636  | TAPPING SCREW (W/WASHER) D4X25         | 2        |  |
| 124      | 992-802  | TAPPING SCREW D6X25                    | 2        |  |
| * 125    | 992-807  | CHOKE COIL                             | 1        | FOR NZL  |
| * 126    | 938-307Z | PILLAR TERMINAL                        | 1        | FOR GBR,ITA,FRG,FRA,ESP,HOL,DEN,FIN,<br>SWE,AUT,SIN        |

\*: ALTERNATIVE PARTS

1 - 92

**PARTS**

**DH 38YB**

| ITEM NO. | CODE NO. | DESCRIPTION                           | NO. USED | REMARKS           |
|----------|----------|---------------------------------------|----------|-------------------|
| 127      | 984-750  | TAPPING SCREW (W/FLANGE) D4X18        | 2        |                   |
| 128      | 980-286  | CORD CLIP                             | 1        |                   |
| 129      | 987-261  | RETAINING RING FOR D17 SHAFT          | 1        |                   |
| 130A     | 990-148  | DISTANCE PIECE (A)                    | 4        |                   |
| 131A     | 993-903  | CRANK COVER ASS'Y                     | 1        | INCLUD.33,35,130A |
| 132      | 991-712  | HEX. SOCKET HD. BOLT (W/FLANGE) M6X25 | 4        |                   |
| 133      | 982-411  | HEX. SOCKET HD. BOLT (W/FLANGE) M6X50 | 4        |                   |
|          |          |                                       |          |                   |
|          |          |                                       |          |                   |
|          |          |                                       |          |                   |
|          |          |                                       |          |                   |
|          |          |                                       |          |                   |
|          |          |                                       |          |                   |
|          |          |                                       |          |                   |
|          |          |                                       |          |                   |
|          |          |                                       |          |                   |
|          |          |                                       |          |                   |
|          |          |                                       |          |                   |
|          |          |                                       |          |                   |
|          |          |                                       |          |                   |
|          |          |                                       |          |                   |
|          |          |                                       |          |                   |
|          |          |                                       |          |                   |
|          |          |                                       |          |                   |
|          |          |                                       |          |                   |
|          |          |                                       |          |                   |
|          |          |                                       |          |                   |
|          |          |                                       |          |                   |
|          |          |                                       |          |                   |
|          |          |                                       |          |                   |
|          |          |                                       |          |                   |
|          |          |                                       |          |                   |
|          |          |                                       |          |                   |
|          |          |                                       |          |                   |
|          |          |                                       |          |                   |
|          |          |                                       |          |                   |
|          |          |                                       |          |                   |
|          |          |                                       |          |                   |
|          |          |                                       |          |                   |
|          |          |                                       |          |                   |
|          |          |                                       |          |                   |
|          |          |                                       |          |                   |
|          |          |                                       |          |                   |
|          |          |                                       |          |                   |
|          |          |                                       |          |                   |

**STANDARD ACCESSORIES**

| ITEM NO. | CODE NO. | DESCRIPTION             | NO. USED | REMARKS            |
|----------|----------|-------------------------|----------|--------------------|
| 501      | 985-389  | STEEL CASE              | 1        |                    |
| 502      | 981-840  | GREASE A (30G)          | 1        |                    |
| 503      | 944-459  | HEX. BAR WRENCH 5MM     | 1        |                    |
| 504      | 985-785  | DUST COVER              | 2        |                    |
| * 505    | 987-018  | K - TAPER SHANK ADAPTER | 1        | INCLUD.506 FOR AUS |
| * 506    | 987-007  | COTTER                  | 1        | FOR AUS            |
|          |          |                         |          |                    |
|          |          |                         |          |                    |
|          |          |                         |          |                    |
|          |          |                         |          |                    |
|          |          |                         |          |                    |
|          |          |                         |          |                    |
|          |          |                         |          |                    |
|          |          |                         |          |                    |
|          |          |                         |          |                    |
|          |          |                         |          |                    |
|          |          |                         |          |                    |
|          |          |                         |          |                    |
|          |          |                         |          |                    |
|          |          |                         |          |                    |
|          |          |                         |          |                    |
|          |          |                         |          |                    |
|          |          |                         |          |                    |
|          |          |                         |          |                    |
|          |          |                         |          |                    |
|          |          |                         |          |                    |
|          |          |                         |          |                    |
|          |          |                         |          |                    |
|          |          |                         |          |                    |
|          |          |                         |          |                    |
|          |          |                         |          |                    |
|          |          |                         |          |                    |
|          |          |                         |          |                    |
|          |          |                         |          |                    |
|          |          |                         |          |                    |
|          |          |                         |          |                    |
|          |          |                         |          |                    |
|          |          |                         |          |                    |
|          |          |                         |          |                    |

\*: ALTERNATIVE PARTS