

HITACHI

ELECTRIC TOOL PARTS LIST

■ HAMMER DRILL
Model VR-38

1995 · 9 · 8
(E7)

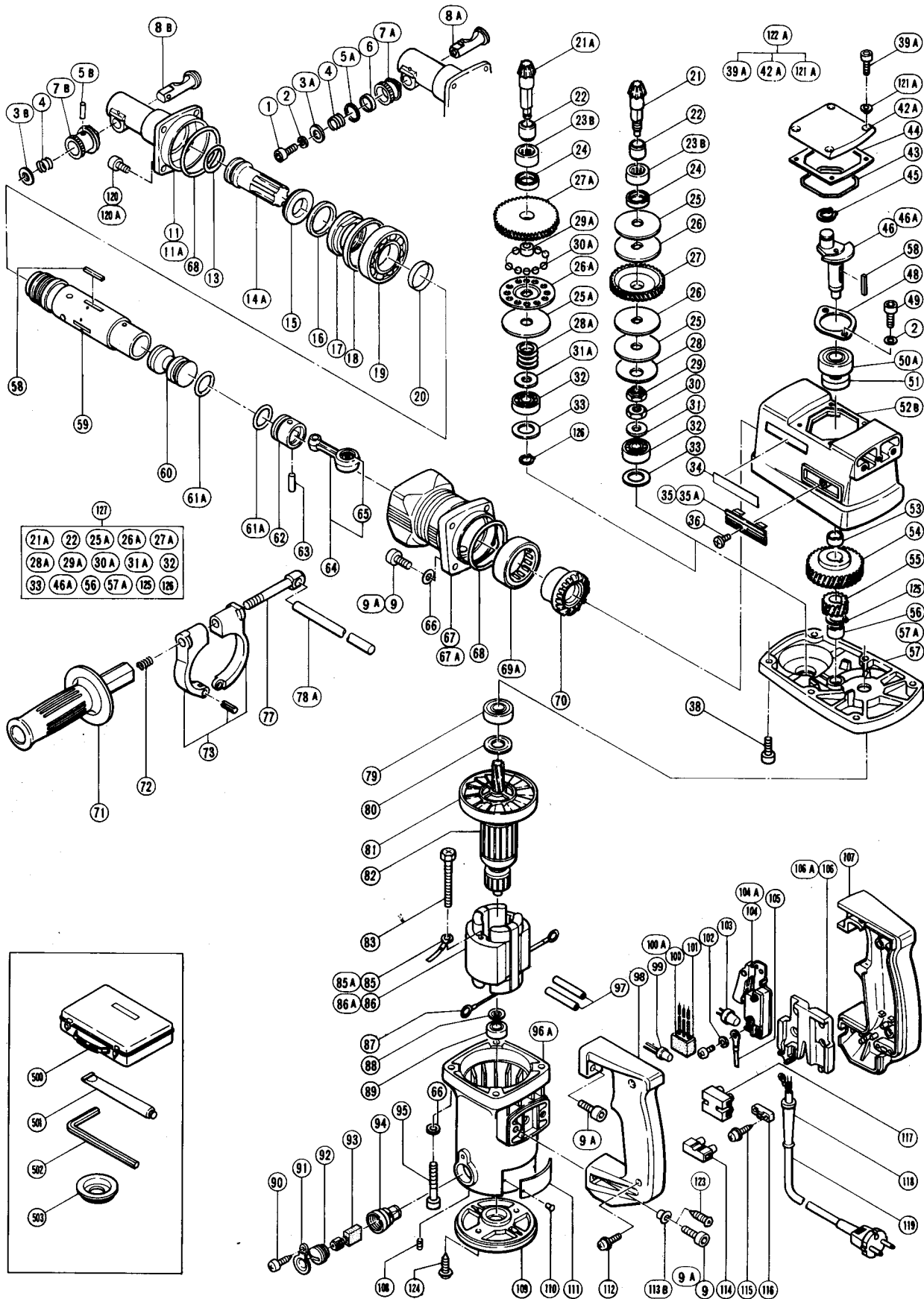

PARTS

VR-38

ITEM NO.	CODE NO.	DESCRIPTION	NO. USED	REMARKS
1	949-765	HEX. SOCKET HD. BOLT M5X12 (10 PCS.)	1	TILL 12.1981
2	949-454	SPRING WASHER M5 (10 PCS.)	2	TILL 2.1987
* 3A	981-886	WASHER (A)	1	TILL 12.1981 (TILL 10.1981 FOR ITA,SWE)
* 3B	983-242	STOP WASHER	1	SINCE 1.1982 (SINCE 11.1981 FOR ITA,SWE)
4	981-937	STOPPER SPRING	1	
* 5A	981-887	WASHER (B)	1	TILL 12.1981 (TILL 10.1981 FOR ITA,SWE)
* 5B	943-364	NEEDLE ROLLER D4X20	1	SINCE 1.1982 (SINCE 11.1981 FOR ITA,SWE)
* 6	981-888	RUBBER WASHER	1	TILL 12.1981 (TILL 10.1981 FOR ITA,SWE)
* 7A	981-936	KNOB	1	TILL 12.1981 (TILL 10.1981 FOR ITA,SWE)
* 7B	983-241	KNOB (A)	1	SINCE 1.1982 (SINCE 11.1981 FOR ITA,SWE)
* 8A	980-722	STOP LEVER	1	TILL 12.1981 (TILL 10.1981 FOR ITA,SWE)
* 8B	983-240	STOP LEVER	1	SINCE 1.1982 (SINCE 11.1981 FOR ITA,SWE)
9	949-652	HEX. SOCKET HD. BOLT M6X25 (10 PCS.)	8	TILL 11.1984
9A	991-700	SEAL LOCK HEX. SOCKET HD. BOLT M6X28	4	SINCE 12.1984
9	949-652	HEX. SOCKET HD. BOLT M6X25 (10 PCS.)	4	SINCE 12.1984 (FROM 12.1984 TO 2.1987, 2PCS. FOR HANDLE(B))
11	981-865	FRONT COVER	1	TILL 12.1984
11A	982-423	FRONT COVER	1	SINCE 1.1985
13	981-857	O - RING (C)	1	
14A	990-144	SECOND HAMMER	1	
15	981-862	DAMPER WASHER	1	
16	981-861	DAMPER	1	
17	981-860	CYLINDER CAP	1	
18	981-859	URETHANE RING	1	
19	600-7DD	BALL BEARING 6007DDUAV2S	1	
20	981-858	VALVE BAND	1	
* 21	981-849	THIRD PINION	1	(TILL 5.1990 FOR ITA ONLY)
* 21A	992-796	THIRD PINION	1	SINCE 6.1990 FOR ITA
22	981-850	SLEEVE	1	
23B	981-852	NEEDLE BEARING (A) HK2012	1	
24	981-851	OIL SEAL (B)	1	
* 25	956-207	SLIP PLATE (B)	2	(TILL 5.1990 FOR ITA ONLY)
* 25A	992-793	PLATE	1	SINCE 6.1990 FOR ITA
* 26	981-941	CLUTCH PLATE	2	(TILL 5.1990 FOR ITA ONLY)
* 26A	992-792	HOLDER	1	SINCE 6.1990 FOR ITA
* 27	981-848	SECOND GEAR	1	(TILL 5.1990 FOR ITA ONLY)
* 27A	992-795	SECOND GEAR	1	SINCE 6.1990 FOR ITA
* 28	944-514	BELLEVILLE SPRING	1	(TILL 5.1990 FOR ITA ONLY)
* 28A	992-794	SPRING	1	SINCE 6.1990 FOR ITA
* 29	981-884	SPECIAL NUT (B)	1	(TILL 5.1990 FOR ITA ONLY)
* 29A	992-806	METAL	1	SINCE 6.1990 FOR ITA
* 30	981-883	SPECIAL NUT (A)	1	(TILL 5.1990 FOR ITA ONLY)
* 30A	959-150	STEEL BALL D6.35 (10 PCS.)	12	SINCE 6.1990 FOR ITA
* 31	944-516	BEARING WASHER (B)	1	(TILL 5.1990 FOR ITA ONLY)
* 31A	992-791	WASHER	1	SINCE 6.1990 FOR ITA
32	629-VVM	BALL BEARING 629VVMC2EPS2L	1	
33	944-525	BEARING WASHER (C)	1	
34	957-561	HITACHI LABEL	1	
35	980-735	WIND GUIDE	2	TILL 7.1987
35A	991-713	WIND GUIDE (B)	2	SINCE 8.1987
36	949-322	FLAT HD. SCREW M4X10 (10 PCS.)	2	TILL 7.1987

*: ALTERNATIVE PARTS

PARTS

VR-38

ITEM NO.	CODE NO.	DESCRIPTION	NO. USED	REMARKS
38	949-660	HEX. SOCKET HD. BOLT M6X20 (10 PCS.)	2	
39A	983-182	SEAL LOCK HEX. SOCKET HD. BOLT M4X12	4	
42A	993-903	CRANK COVER ASS'Y	1	
43	980-744	O - RING (S - 55)	1	
44	980-749	SEAL PACKING	1	
45	939-542	RETAINING RING FOR D12 SHAFT (10 PCS.)	1	
* 46	981-844	CRANK SHAFT	1	(TILL 5.1990 FOR ITA ONLY)
* 46A	991-954	CRANK SHAFT	1	SINCE 6.1990 FOR ITA
48	981-847	BEARING COVER	1	
49	949-665	HEX. SOCKET HD. BOLT M5X14 (10 PCS.)	4	(TILL 2.1987,2PCS. FOR TAIL COVER)
50A	620-3DD	BALL BEARING 6203DDUCMAV2S	1	
51	971-745	OIL SEAL (A)	1	
52B	991-768	CRANK CASE ASS'Y	1	INCLUD.23B,24,35A
53	980-706	COLLAR	1	
54	981-845	FIRST GEAR	1	
55	981-846	SECOND PINION	1	
56	939-299	NEEDLE BEARING (M661)	1	
* 57	981-952	GEAR COVER	1	(TILL 5.1990 FOR ITA ONLY)
* 57A	991-953	GEAR COVER	1	SINCE 6.1990 FOR ITA
58	971-750	FEATHER KEY 3X3X20	5	
59	981-935	CYLINDER	1	
60	981-855	STRIKER	1	
61A	986-104	O - RING	2	
62	981-885	PISTON	1	
63	980-708	PISTON PIN	1	
64	980-707	CONNECTING ROD ASS'Y	1	INCLUD.65
65	980-756	NEEDLE BEARING (NSK AJ50 1203)	1	
66	949-432	BOLT WASHER M6 (10 PCS.)	12	(TILL 8.1986 FOR HANDLE)
66	949-432	BOLT WASHER M6 (10 PCS.)	8	SINCE 9.1986
67	982-425	CYLINDER CASE	1	TILL 12.1984
67A	982-410	CYLINDER CASE	1	SINCE 1.1985
68	958-996	O - RING (1AS - 60)	2	
69A	993-069	NEEDLE BEARING (B) (NTN HMK4520)	1	
70	981-854	THIRD GEAR	1	
71	981-870	SIDE HANDLE	1	
72	672-612	SPRING	1	
73	981-960	HANDLE HOLDER	1	
77	971-785	HANDLE BOLT	1	
78A	971-786	STOPPER ROD	1	
79	620-2VV	BALL BEARING 6202VVCMP2S	1	
80	980-700	DUST WASHER (B)	1	
81	980-740	FAN	1	
* 82	981-971U	ARMATURE ASS'Y 110V - 115V	1	INCLUD.79 - 81,88,89
* 82	981-971D	ARMATURE ASS'Y 120V - 127V	1	INCLUD.81
* 82	981-971E	ARMATURE ASS'Y 220V - 230V	1	INCLUD.81
* 82	981-971F	ARMATURE ASS'Y 240V	1	INCLUD.81
83	960-251	HEX. HD. TAPPING SCREW D5X65	2	
* 85	971-776	INTERNAL WIRE	1	
* 85	971-825	INTERNAL WIRE	1	FOR FIN,AUT
* 85A	986-277	INTERNAL WIRE	1	FOR SAF,ITA
* 86	981-970C	STATOR ASS'Y 110V - 115V	1	INCLUD.87

*: ALTERNATIVE PARTS

PARTS

VR-38

ITEM NO.	CODE NO.	DESCRIPTION	NO. USED	REMARKS
* 86	981-970D	STATOR ASS'Y 120V - 127V	1	INCLUD.87
* 86	981-970E	STATOR ASS'Y 220V - 230V	1	INCLUD.87
* 86	981-970F	STATOR ASS'Y 240V	1	INCLUD.87
* 86	981-970H	STATOR ASS'Y 240V	1	INCLUD.87 FOR AUS
* 86	981-970J	STATOR ASS'Y 110V	1	INCLUD.87 FOR GBR
* 86A	981-970K	STATOR ASS'Y 220V - 230V	1	INCLUD.87 FOR SAF,ITA
87	930-703	BRUSH TERMINAL	2	
88	980-698	DUST WASHER (A)	1	
89	608-VVM	BALL BEARING 608VVMC2EPS2L	1	
90	958-715	TAPPING SCREW D4X10	2	
91	981-959	CAP COVER	2	
92	961-781	BRUSH CAP	2	
93	981-612Z	CARBON BRUSH (AUTO STOP TYPE) (1 PAIR)	2	
94	981-586	BRUSH HOLDER	2	
95	949-782	HEX. SOCKET HD. BOLT M6X50 (10 PCS.)	4	
96A	991-767	HOUSING ASS'Y (B)	1	INCLUD.94,108,123,124
97		VINYL TUBE (ID7XT0.5X170)	2	
98	981-867	HANDLE (B)	1	
99	959-140	CONNECTOR 50091 (10 PCS.)	1	
* 100	994-273	NOISE SUPPRESSOR	1	FOR NZL,FRG,FRA,HOL,DEN,GBR,SUI
* 100A	971-828	NOISE SUPPRESSOR	1	FOR FIN,SAF,ITA,AUT
* 101	930-153	SUPPORT (B)	1	FOR NZL,GBR,SAF,ITA,FRG,HOL,FIN,SUI
102	949-423	WASHER M4 (10 PCS.)	1	
* 103	959-141	CONNECTOR 50092 (10 PCS.)	2	FOR NZL,GBR,SAF,ITA,FRG,FRA,HOL,DEN,SWE
* 104	981-533Z	SWITCH (2P PILLAR TYPE) W/O LOCK	1	FOR AUS
* 104A	992-891	SWITCH (A) (1P SCREW TYPE) W/O LOCK	1	
* 105	981-974Z	INTERNAL WIRE	1	FOR NZL,GBR,SAF,ITA,FRA,HOL,DEN,FIN,SWE
* 106	981-869	SUPPORT	1	TILL 3.1987
* 106	981-986Z	SUPPORT (A)	1	FOR OCEANIA
* 106A	990-082	SUPPORT (E)	1	SINCE 4.1987
107	981-866	HANDLE (A)	1	
108	949-366	SLOTTED HD. SET SCREW M4X6 (10 PCS.)	2	
109	302-323	TAIL COVER (B)	1	
110	949-510	RIVET D2.5X4.8 (10 PCS.)	2	
111		NAME PLATE	1	
112	956-636	TAPPING SCREW (W/WASHER) D4X25	2	
113B	990-940	DISTANCE PIECE (C)	4	
114	938-307	PILLAR TERMINAL	1	
115	930-446	TAPPING SCREW (W/WASHER) D4X16	2	
* 116	960-266	CORD CLIP	1	
* 116	981-987Z	CORD CLIP	1	FOR SUI
* 117	958-308Z	PILLAR TERMINAL (A)	1	FOR FIN
* 118	958-049Z	CORD ARMOR D8.2	1	
* 118	940-778	CORD ARMOR D10.7	1	
* 119	500-239Z	CORD	1	(CORD ARMOR D10.7)
* 119	500-224Z	CORD	1	(CORD ARMOR D10.7) FOR SIN
* 119	500-227Z	CORD	1	(CORD ARMOR D8.2) FOR OCEANIA
* 119	500-235Z	CORD	1	(CORD ARMOR D8.2) FOR ITA,FRG,FRA
* 119	500-249Z	CORD	1	(CORD ARMOR D8.2) FOR USA,CAN
* 119	500-390Z	CORD	1	(CORD ARMOR D10.7) FOR DEN,FIN,SWE,HOL.
				AUT

*: ALTERNATIVE PARTS

9-95

PARTS

VR-38

ITEM NO.	CODE NO.	DESCRIPTION	NO. USED	REMARKS
* 119	500-391Z	CORD	1	(CORD ARMOR D10.7) FOR SUI
* 119	500-394Z	CORD	1	(CORD ARMOR D10.7) FOR SYR
* 119	500-406Z	CORD	1	(CORD ARMOR D8.2) FOR SAF,GBR
120	981-942	SEAL LOCK HEX. SOCKET HD. BOLT M6X25	4	TILL 12.1984
120A	981-898	SEAL LOCK BOLT M7X25	4	SINCE 1.1985
121A	990-146	DISTANCE PIECE (A)	4	
122A	993-903	CRANK COVER ASS'Y	1	INCLUD.39A,42A,121A
123	992-802	TAPPING SCREW D6X25	2	SINCE 3.1987
124	985-480	TAPPING SCREW (W/WASHER) D5X20	2	SINCE 3.1987
* 125	967-261	RETAINING RING FOR D17 SHAFT	1	SINCE 6.1990 FOR ITA
* 126	992-805	RETAINING RING FOR D9 SHAFT	1	SINCE 6.1990 FOR ITA
* 127	985-490	SLIP CLUTCH ASS'Y	1	INCLUD.21A,22,25A - 31A,32,33,46A,56,57A, 125,126 FOR ITA

STANDARD ACCESSORIES

ITEM NO.	CODE NO.	DESCRIPTION	NO. USED	REMARKS
500	985-389	CASE (STEEL)	1	
501	981-840	GREASE (A) FOR HAMMER.HAMMER DRILL (30G)	1	
502	944-459	HEX. BAR WRENCH 5MM	1	
503	981-875	DUST COVER (A)	3	

OPTIONAL ACCESSORIES

ITEM NO.	CODE NO.	DESCRIPTION	NO. USED	REMARKS
601	944-460	TAPER SHANK DRILL BIT D11X100	1	
602	944-461	TAPER SHANK DRILL BIT D12.3X110	1	
603	944-462	TAPER SHANK DRILL BIT D14.3X110	1	
604	944-463	TAPER SHANK DRILL BIT D17.5X120	1	
605	944-464	TAPER SHANK DRILL BIT D21.5X140	1	
606	944-477	COTTER	1	
607	944-500	TAPER SHANK DRILL BIT D14.5X110	1	
608	944-574	DRIFT KEY	1	FOR ANCHOR REMOVAL
609	944-575	SYRINGE	1	FOR CHIP REMOVAL
610	955-154	CORE BIT 45MM	1	
611	955-155	CORE BIT 54MM	1	
612	955-157	CORE BIT 79MM	1	
613	955-159	CORE BIT 105MM	1	
614	955-163	CORE BIT SHANK (A) 300L (FOR D38 - 120)	1	FOR 35MM OR BELOW
615	955-165	CENTER PIN (A) 133L FOR CORE BIT D38 - 150	1	FOR 35MM OR BELOW

*: ALTERNATIVE PARTS

OPTIONAL ACCESSORIES

VR-38

ITEM NO.	CODE NO.	DESCRIPTION	NO. USED	REMARKS
616	955-166	GUIDE PLATE (FOR CORE BIT 45MM)	1	
617	955-167	GUIDE PLATE (FOR CORE BIT 54MM)	1	
618	955-168	GUIDE PLATE (FOR CORE BIT 79MM)	1	
619	955-169	GUIDE PLATE (FOR CORE BIT 105MM)	1	
620	955-994	CORE BIT 25MM	1	
621	955-995	CORE BIT 29MM	1	
622	955-996	CORE BIT 32MM	1	
623	955-997	GUIDE PLATE (FOR CORE BIT 32MM)	1	
624	955-998	CORE BIT 35MM	1	
625	955-999	GUIDE PLATE (FOR CORE BIT 35MM)	1	
626	956-000	CORE BIT 38MM	1	
627	956-001	GUIDE PLATE (FOR CORE BIT 38MM)	1	
628	956-002	CORE BIT 64MM	1	
629	956-003	GUIDE PLATE (FOR CORE BIT 64MM)	1	
630	956-004	CORE BIT 94MM	1	
631	956-005	GUIDE PLATE (FOR CORE BIT 94MM)	1	
632	956-008	CORE BIT SHANK (B) 300L (FOR D25 - 35)	1	FOR 38MM OR ABOVE
633	956-009	CENTER PIN (B) 147L FOR CORE BIT D32 - 35	1	FOR 38MM OR ABOVE
634	980-927	GREASE FOR HAMMER.HAMMER DRILL (500G)	1	
635	981-922	BULL POINT 280MM (ROUND SHANK TYPE)	1	
636	981-923	BULL POINT 450MM (ROUND SHANK TYPE)	1	
637	981-924	CUTTER W45X280L (ROUND SHANK TYPE)	1	
638	981-925	COLD CHISEL 280MM (ROUND SHANK TYPE)	1	
639	981-926	COLD CHISEL 450MM (ROUND SHANK TYPE)	1	
640	985-720	DRILL BIT D16.0X400 (HEX. SHANK TYPE)	1	
641	985-721	DRILL BIT D16.0X280 (HEX. SHANK TYPE)	1	
642	985-722	DRILL BIT D16.0X505 (HEX. SHANK TYPE)	1	
643	985-723	DRILL BIT D19.0X400 (HEX. SHANK TYPE)	1	
644	985-724	DRILL BIT D19.0X280 (HEX. SHANK TYPE)	1	
645	985-725	DRILL BIT D19.0X505 (HEX. SHANK TYPE)	1	
646	985-726	DRILL BIT D22.0X400 (HEX. SHANK TYPE)	1	
647	985-727	DRILL BIT D22.0X280 (HEX. SHANK TYPE)	1	
648	985-728	DRILL BIT D22.0X505 (HEX. SHANK TYPE)	1	
649	985-729	DRILL BIT D25.0X400 (HEX. SHANK TYPE)	1	
650	985-730	DRILL BIT D25.0X280 (HEX. SHANK TYPE)	1	
651	985-731	DRILL BIT D25.0X505 (HEX. SHANK TYPE)	1	
652	985-732	DRILL BIT D28.0X400 (HEX. SHANK TYPE)	1	
653	985-733	DRILL BIT D28.0X280 (HEX. SHANK TYPE)	1	
654	985-734	DRILL BIT D28.0X505 (HEX. SHANK TYPE)	1	
655	985-735	DRILL BIT D32.0X400 (HEX. SHANK TYPE)	1	
656	985-736	DRILL BIT D32.0X280 (HEX. SHANK TYPE)	1	
657	985-737	DRILL BIT D32.0X505 (HEX. SHANK TYPE)	1	
658	985-738	DRILL BIT D38.0X400 (HEX. SHANK TYPE)	1	
659	985-739	DRILL BIT D38.0X280 (HEX. SHANK TYPE)	1	
660	985-740	DRILL BIT D38.0X505 (HEX. SHANK TYPE)	1	
661	985-750	DRILL ADAPTER NO.1 (D11.0 - 17.5)	1	
662	985-751	DRILL ADAPTER NO.2 (D21.5)	1	
663	985-752	TAPER SHANK ADAPTER NO.1	1	INCLUD.806
664	985-753	TAPER SHANK ADAPTER NO.2	1	INCLUD.806
665	985-754	A - TAPER SHANK ADAPTER (D11.0 - 17.5)	1	
666	985-755	B - TAPER SHANK ADAPTER (D21.5)	1	

*: ALTERNATIVE PARTS

